



Recommended Uses

Foreground Music
Background Music
Audio Systems
Video Systems
AV / Home Theater



Invisible Subwoofer

The Stealth Acoustics model B22G is a compact, tonal monaural subwoofer speaker system that becomes completely invisible after installation. The subwoofer is mounted on a rigid frame that attaches directly to standard structural framing. The paintable active diaphragm face is bonded

to the frame of the speaker panel, creating an active area surrounded by a stable mounting area. [Installation instructions](#) are shown on a paper overlay that is to be removed before installation. This overlay can also be used as a cutting template for retrofitting the speakers into existing wallboard. The B22G may be installed in either the wall or ceiling and on-site finishing options include late light wallpaper, fabrics and selected texture coats. There is no need for special vellums or other nonstandard wallboard finishing materials. Advanced finishing methods such as Venetian plaster and select veneers are supported using special techniques.

Ideal for any surround sound, foreground music or whole-house audio system that needs extra output, each B22G panel incorporates an acoustically coupled, high-quality, high-power 8" (203 mm) cone woofer. The panels work in pairs as a monaural output subwoofer. This two-panel system requires each panel to be placed wherever they perform best, free of visual concerns that may conflict with architectural features. B22G panels may be mounted separately or stacked to achieve desired acoustical results. For stereo subwoofers, four panels should be employed.

Using acoustic lever principals, the B22G provides exceptional bass output from 30Hz to 150Hz, trading off excursion for surface area to propagate bass waveforms. Each panel has 228 sq. in. (1470 sq. cm) of active area for a total of 456 sq. in. (2940 sq. cm) for both panels.

Stealth Acoustics recommends the companion [Model 255R](#) 250-watt subwoofer amplifier/cross matched amplifier for the B22G subwoofer speakers. Stealth Acoustics also offers a line of full-speaker panels that when combined with the B22G, deliver a complete, totally invisible audio system.

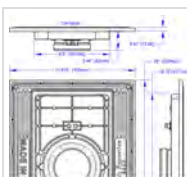

Specification Sheet: [Download PDF](#)

Installation Instructions: [Download PDF](#) | [View Instructions](#) | [See Video](#)

Dimensional Drawings: [Download PDF](#)

Test Results: [Download PDF](#)

Frequency Response:

30Hz to 150Hz

Power Capacity:

80 watts RMS

50 watts minimum recommended power

Sensitivity:

86 dB (1 watt / 1 meter)

Driver Components:

One 8" (203 mm) woofers and one 1-1/2" (38 mm) voice coil per panel

One ceramic 20 oz. (622 gr) magnet

System Impedance:

8Ω nominal

Polar Dispersion:

170 degrees vertical and horizontal

Crossover Frequency:

Requires amplifier with low pass filter. 50Hz with 18 dB slope recommended

Dimensions:

Width: 15-7/8" (403 mm)

Height: 22" (559 mm)

Mounting Depth: 2-1/2" (64 mm)

Product Weight:

10.5 lbs. (4.8 kg) each

Shipping Weight:

30 lbs. (13.6 kg) per pair

Included Accessories:

Mounting shims

Mounting screws

Terminal wrench

Optional Accessories:

[PS-22](#) PlaceSaver®

[BX-22](#) MDF Acoustic Back Box

[MBX-22](#) UL Listed Metal Back Box

[MBA-22](#) UL Listed Metal Back Box – Adjustable

[MBC-22](#) Concrete Back Box

[SK-1](#) Shim Kit

[Warranty](#) – Extended Warranty 15 year



Recommended Uses

Foreground Music
Background Music
Audio Systems
Video Systems
AV / Home Theater



B30G Invisible Subwoofer

The Stealth Acoustics Model B30G is a two-panel monaural subwoofer speaker system that becomes completely invisible after installation. The subwoofer has a rigid frame that is attached directly to standard structural framing. The paintable acoustic diaphragm face is bonded to the frame of the speaker panel, creating an active area surrounded by a stable mounting structure.

Installation instructions are shown on a paper overlay that is to be removed before installation. The overlay can also be used as a cutting template for retrofitting the speakers into existing wallboards.

The B30G may be installed in either the wall or ceiling and on-site finishing options include latex paint, light wallpaper, fabrics and selected texture coats. There is no need for special vellums or other nonstandard wallboard finishing materials. Advanced finishing methods may be supported using standard techniques.

Ideal for any surround sound, foreground music or whole-house audio system that needs extra bass output, each B30G panel incorporates two acoustically coupled, high-quality, high-power 8" (203 mm) cone woofers. The panels work in pairs as a monaural output subwoofer. This two-panel system allows each panel to be placed wherever they perform best, free of visual concerns that may conflict with architectural features. B30G panels may be mounted separately or stacked to achieve desired acoustical results. For stereo subwoofers, four panels should be employed.

Using acoustic lever principals, the B30G provides exceptional bass output from 20Hz to 160Hz trading off excursion for surface area to propagate bass waveforms. Each panel has 331 sq. in. (2140 sq. cm) of active area for a total of 662 sq. in. (4260 sq. cm) for both panels – nearly twice that of a 12" (304 mm) woofer.

Stealth Acoustics recommends the companion Model 255R 250-watt subwoofer amplifier/cross-over matched amplifier for the B30G subwoofer speakers. Stealth Acoustics also offers a line of full-range speaker panels that when combined with the B30G, deliver a complete, totally invisible audio system.

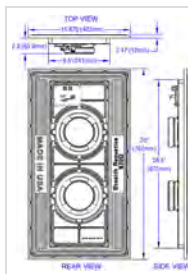

Specification Sheet: [Download PDF](#)

Installation Instructions: [Download PDF](#) | [View Instructions](#) | [See Video](#)

Dimensional Drawings: [Download PDF](#)

Test Results: [Download PDF](#)

Frequency Response:

20Hz to 160Hz

Power Capacity:

100 watts RMS

60 watts minimum recommended power

Sensitivity:

86 dB (1 watt / 1 meter)

Driver Components:

Two 8" (203 mm) woofers with 1-1/2" (38 mm) voice coils per panel

Two ceramic 20 oz. (622 gr) magnets

System Impedance:

The impedance may be changed from 4Ω (in parallel) to 16Ω (in series) via a jumper on the back of the panel.

Polar Dispersion:

170 degrees vertical and horizontal

Crossover Frequency:

Requires amplifier with low pass filter. 50Hz with 18 dB slope recommended

Dimensions:

Width: 15-7/8" (403 mm)

Height: 30" (762 mm)

Mounting Depth: 2-1/2" (64 mm)

Product Weight:

20 lbs. (9.1 kg) each

Shipping Weight:

46 lbs. (21 kg) per pair

Included Accessories:

Mounting shims

Mounting screws

Terminal wrench

Optional Accessories:

[PS-30 PlaceSaver®](#)

[BX-30 MDF Acoustic Back Box](#)

[MBX-30 UL Listed Metal Back Box](#)

[MBA-30 UL Listed Metal Back Box – Adjustable](#)



ed Uses

io Systems

sic

sic

1 / Home Theater
ement

LR3G

3-Way Invisible In-Wall or In Ceiling Loudspeaker

The Stealth Acoustics model LR3G is a three-way, full-range loudspeaker system that becomes completely invisible upon installation. The loudspeaker has a rigid frame that attaches directly to standard structural framing. The paintable active diaphragm face is bonded to the frame of the speaker panel, creating an active area surrounded by a stable mounting area. [Installation instructions](#) are shown on a paper overlay that is removed before installation. The overlay can also be used as a cutting template for retrofitting speakers into existing wallboard.

The LR3G may be installed in either the wall or ceiling and on-site finishing options include latex paint, wallpaper, fabrics and selected texture coats. There is no need for special vellums or other nonstandard wallboard finishing materials. Advanced finishing methods such as Venetian plaster and select veneers are supported using special techniques.

The Stealth Acoustics LR3G incorporates an acoustically coupled high quality, high-power 8" woofer and direct coupled 25 mm neo-magnet high-frequency drivers. Advanced internal baffle materials allow for smooth frequency extension to 20 kHz. When the LR3G is installed in standard insulated 2" x 4" framing and allowed to function in a full 8 foot stud bay, frequency response to 100 Hz can be achieved. The LR3G contains three independent protection circuits (low, mid-range and high frequency sections) that automatically reset upon reduction of excessive amplifier power.

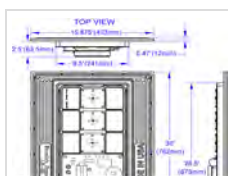

Specification Sheet: [Download PDF](#)

Installation Instructions: [Download PDF](#) | [View Instructions](#) | [See Video](#)

Dimensional Drawings: [Download PDF](#)

Test Results: [Download PDF](#)

Frequency Response:

40Hz to 20kHz

Power Capacity:

200 watts RMS

75 watts minimum recommended power

Protection:

Three independent self-resetting devices (low, mid-range and high frequency)

Sensitivity:

81 dB (1 watt / 1 meter)

Driver Components:

High frequency:

1" (25 mm) neodymium motor

Midrange frequency:

Two 1" (25 mm) neodymium motors

Low-frequency:

1.5" (38 mm) voice coil, 8" (203 mm) woofer

Ceramic 20 oz. (622 gr) magnet

System Impedance:

8Ω nominal

Polar Dispersion:

170 degrees vertical and horizontal

Dimensions:

Width: 15-7/8" (403 mm)

Height: 30" (762 mm)

Mounting Depth: 2-1/2" (64 mm)

Product Weight:

19 lbs. (8.8 kg) each

Shipping Weight:

44 lbs. (20 kg) per pair

26 lbs. (11.8 kg) per single

Included Accessories:

Mounting shims

Mounting screws

Terminal wrench

Optional Accessories:

[PS-30 PlaceSaver®](#)

[BX-30 MDF Acoustic Back Box](#)

[MBX-30 UL Listed Metal Back Box](#)

[MBA-30 UL Listed Metal Back Box – Adjustable](#)

[MBC-30 Concrete Back Box](#)

[SK-1 Shim Kit](#)

[CVXMR 100, 75 and 25 volt Constant Voltage Transformers](#)

[WARRANTY](#) – Extended Warranty 15 year



ed Uses

- Surround Sound
- Room Audio Systems
- Music
- Home Theater
- Commercial
- Installation



Full Range 6-Element Premium Invisible Speaker

The Stealth Acoustics model LR4G is a Planar-front, titanium system; 3-way passive, in-wall or in ceiling loudspeaker that becomes completely invisible after installation. The paintable active diaphragm face is bonded to the frame of the speaker panel, creating an active area surrounded by a stable mounting area. [Installation instructions](#) are shown on a paper overlay that is to be removed before installation. The overlay can be used as a cutting template for retrofitting the speakers into existing wallboard.

The LR4G may be installed in either the wall or ceiling and on-site finishing options include latex paint, light wallpaper, fabrics and selected texture coats. There is no need for special vellums or other nonstandard wallboard finishing materials. Advanced finishing methods such as Venetian plaster and select veneers are supported using special techniques.

The Stealth Acoustics LR4G is designed to work in conjunction with the LR4G-LF low frequency driver (included) to complete its full-range capabilities. The LR4G incorporates four direct-to-fiber neodymium midrange motors and one direct-to-fiber neodymium high-frequency motor aligned in the new St Quad-Balanced Midrange Driver™ configuration. Advanced internal carbon fiber materials allow for a smooth frequency extension to 20 kHz. When the LR4G is installed in standard insulated 2" x 4" framing and allowed to function in a full 8 foot stud bay, frequency response below 45 Hz can be achieved. The LR4G contains three independent protection circuits (low, mid-range and high frequency sections) that automatically reset upon reduction of excessive amplifier power.

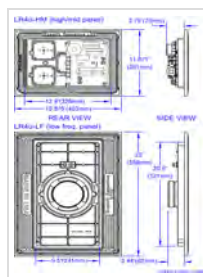

- Specification Sheet: [Download PDF](#)
- Installation Instructions: [Download PDF](#) | [View Instructions](#) | [See Video](#)
- Dimensional Drawings: [Download PDF](#)
- Test Results: [Download PDF](#)

<p>Frequency Response: 45Hz to 20kHz</p> <p>Power Capacity: 200 watts RMS</p> <p>100 watts minimum recommended power</p> <p>Protection: Three independent self-resetting devices (low, mid-range and high frequency)</p> <p>Sensitivity: 80 dB (1 watt / 1 meter)</p> <p>Driver Components: High frequency: 1" (25 mm) neodymium motor</p> <p>Midrange frequency: Four 1" (25 mm) neodymium motors</p> <p>Low-frequency: 1.5" (38 mm) voice coil, 8" (203 mm) woofer</p> <p>Ceramic 20 oz (622 gr) magnet</p> <p>System Impedance: 4Ω nominal</p> <p>Polar Dispersion: 170 degrees vertical and horizontal</p>	<p>Dimensions: Width: 15-7/8" (403 mm)</p> <p>Height: 34" (863 mm)</p> <p>Mounting Depth: 2-3/4" (70 mm)</p> <p>Product Weight: 26 lbs. (12 kg) each</p> <p>Shipping Weight: 55 lbs. (25 kg) per pair</p> <p>30 lbs. (14 kg) per single</p> <p>Included Accessories: Mounting shims</p> <p>Mounting screws</p> <p>Terminal wrench</p> <p>Optional Accessories: PS-12 PlaceSaver® (HM Panel)</p> <p>PS-22 PlaceSaver® (LF Panel)</p> <p>MBX-12 Metal Back Box (HM Panel)</p> <p>MBX-22 UL Listed Metal Back Box (LF Panel)</p> <p>MBA-22 UL Listed Metal Back Box – Adjustable (HM & LF Panel)</p> <p>MBC-12 Concrete Back Box (HM Panel)</p> <p>MBC-22 Concrete Back Box (LF Panel)</p> <p>SK-1 Shim Kit</p>
---	---



ed Uses
io Systems
sic
sic

1 / Home Theater
Systems



6.5" 2-Way Full Range Speakers

The Stealth Acoustics model LR6G is a two-way, full-range loudspeaker system that becomes completely invisible at installation. The loudspeaker has a rigid frame that attaches directly to standard structural framing. The paintable ac

diaphragm face is bonded to the frame of the speaker panel, creating an active area surrounded by a stable mounting area. [Installation instructions](#) are shown on a paper overlay that is to be removed at installation. The overlay can also be used as a cutting template for retrofitting the speakers into wallboard.

The LR6G may be installed in either the wall or ceiling and on-site finishing options include latex paint, light wallpaper, fabrics and selected texture coats. There is no need for special vellums or other nonstandard wallboard finishing materials. Advanced finishing methods such as Venetian plaster and select veneers are supported using special techniques.

The Stealth Acoustics LR6G incorporates an acoustically coupled high quality, high-power 6.5" woofer and a direct coupled 30 mm neo-magnet high-frequency motor. Advanced internal carbon fiber materials allow for smooth frequency extension to 20kHz. When the LR6G is installed in standard insulated 2" x 4" framing and allowed to function in a full 8 foot stud bay, frequency response below 45Hz can be achieved. The LR6G contains two independent protection circuits (high-frequency and low-frequency sections) that automatically reset upon reduction of excessive amplifier power.

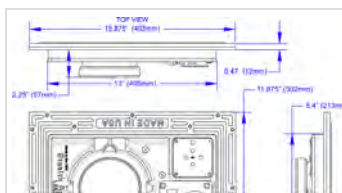

Specification Sheet: [Download PDF](#)

Installation Instructions: [Download PDF](#) | [View Instructions](#) | [See Video](#)

Dimensional Drawings: [Download PDF](#)

Test Results: [RTA PDF](#) / [CLF ZIP](#) / [EASE ZIP](#) / [CViewer](#)

Frequency Response:

45Hz to 20kHz

Power Capacity:

100 watts RMS

50 watts minimum recommended power

Protection:

Two independent self-resetting devices (low and high frequency)

Sensitivity:

83 dB (1 watt / 1 meter)

Driver Components:

High frequency:

1" (30 mm) neodymium motor

Low-frequency:

1" (25 mm) voice coil, 6.5" (165 mm) woofer

Ceramic 20 oz. (622 gr) magnet

System Impedance:

8Ω nominal

Polar Dispersion:

170 degrees vertical and horizontal

Dimensions:

Width: 15-7/8" (403 mm)

Height: 11-7/8" (302 mm)

Mounting Depth: 2-1/4" (58 mm)

Product Weight:

8.7 lbs. (3.9 kg) each

Shipping Weight:

19 lbs. (8.6 kg) per pair

12 lbs. (5.4 kg) per single

Included Accessories:

Mounting shims

Mounting screws

Terminal wrench

Optional Accessories:

[PS-12 PlaceSaver®](#)

[BX-12 MDF Acoustic Back Box](#)

[MBX-12 UL Listed Metal Back Box](#)

[MBA-22 UL Listed Metal Back Box – Adjustable](#)

[MBC-22 Concrete Back Box](#)

[SK-1 Shim Kit](#)

[CVXMR 100, 75 and 25 volt Constant Voltage Transformers](#)

[WARRANTY](#) – Extended Warranty 15 year



ed Uses
io Systems
sic
sic

1 / Home Theater
Systems



8" 2-Way Full Range Speakers

The Stealth Acoustics model LR8G is a two-way, full-range loudspeaker system that becomes completely invisible installation. The loudspeaker has a rigid frame that attaches directly to standard structural framing. The paintable acoustically transparent diaphragm face is bonded to the frame of the speaker panel, creating an active area surrounded by a stable mounting area. [Installation instructions](#) are shown on a paper overlay that is to be removed after installation. The overlay can also be used as a cutting template for retrofitting the speakers into wallboard.

The LR8G may be installed in either the wall or ceiling and on-site finishing options include latex paint, light wallpaper, fabrics and selected texture coats. There is no need for special vellums or other nonstandard wallboard finishing materials. Advanced finishing methods such as Venetian plaster and select veneers are supported using special techniques.

The Stealth Acoustics LR8G incorporates an acoustically coupled high quality, high-power 8" woofer and a direct coupled 25 mm neo-magnet high-frequency motor. Advanced internal carbon fiber materials allow for smooth frequency extension to 20 kHz. When the LR8G is installed in standard insulated 2" x 4" framing and allowed to function in a full 8 foot stud bay, frequency response below 20 Hz can be achieved. The LR8G contains two independent protection circuits (high-frequency and low-frequency sections) that automatically reset upon reduction of excessive amplifier power.

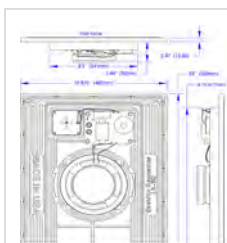

Specification Sheet: [Download PDF](#)

Installation Instructions: [Download PDF](#) | [View Instructions](#) | [See Video](#)

Dimensional Drawings: [Download PDF](#)

Test Results: [Download PDF](#)

Frequency Response:

45hz to 20khz

Power Capacity:

120 watts RMS

60 watts minimum recommended power

Protection:

Two independent self-resetting devices (low and high frequency)

Sensitivity:

83 dB (1 watt / 1 meter)

Driver Components:

High frequency:

1" (25 mm) neodymium motor

Low-frequency:

1" (25 mm) voice coil, 8" (203 mm) woofer

Ceramic 20 oz. (622 gr) magnet

System Impedance:

8Ω nominal

Polar Dispersion:

170 degrees vertical and horizontal

Dimensions:

Width: 15-7/8" (403 mm)

Height: 22" (559 mm)

Mounting Depth: 2-1/2" (64 mm)

Product Weight:

14 lbs. (6.3 kg) each

Shipping Weight:

32 lbs. (14.5 kg) per pair

20 lbs. (9.0 kg) per single

Included Accessories:

Mounting shims

Mounting screws

Terminal wrench

Optional Accessories:

[PS-22 PlaceSaver®](#)

[BX-22 MDF Acoustic Back Box](#)

[MBX-22 UL Listed Metal Back Box](#)

[MBA-22 UL Listed Metal Back Box – Adjustable](#)

[MBC-22 Concrete Back Box](#)

[SK-1 Shim Kit](#)

[CVXMR 100, 75 and 25 volt Constant Voltage Transformers](#)

[WARRANTY](#) – Extended Warranty 15 year



ed Uses
 io Systems
 sic
 sic
 ns where space is limited such as
 athrooms



Full Range, 2-Way Single Stereo Panel

The Stealth Acoustics model SLR8G is a dual channel way, full-range loudspeaker system that becomes completely invisible after installation. The loudspeaker has a rigid frame that attaches directly to standard framing. The paintable active diaphragm face is bonded to the frame of the speaker panel, creating an active area surrounded by a stable mounting area. [Installation instructions](#) are shown on a page that is to be removed before installation. The overlay can also be used as a cutting template for retrofitting the speakers into existing wallboard.

The SLR8G may be installed in either the wall or ceiling and on-site finishing options include latex paint, light wallpaper, fabrics and selected texture coats. There is no need for special vellums or nonstandard wallboard finishing materials. Advanced finishing methods such as Venetian plaster or select veneers are supported using special techniques.

The Stealth Acoustics SLR8G incorporates an acoustically coupled high quality, high-power 8" woofer and two direct coupled 25 mm neo-magnet high-frequency motors. Advanced internal cavity materials allow for smooth frequency extension to 20 kHz. When the SLR8G is installed in standard insulated 2" x 4" framing and allowed to function in a full 8 foot stud bay, frequency response below 40 Hz can be achieved. The SLR8G contains independent crossover sections and protection circuitry (high frequency and low-frequency sections) for each channel that automatically reset upon reduction of excessive amplifier power.

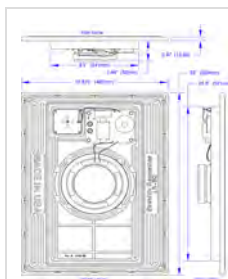

Specification Sheet: [Download PDF](#)

Installation Instructions: [Download PDF](#) | [View Instructions](#) | [See Video](#)

Dimensional Drawings: [Download PDF](#)

Test Results: [Download PDF](#)

Frequency Response:

45Hz to 20kHz

Power Capacity:

120 watts RMS

60 watts minimum recommended power

Protection:

Four independent self-resetting devices (low and high frequency each channel)

Sensitivity:

82 dB (1 watt / 1 meter)

Driver Components:

High frequency:

Two 1" (25 mm) neodymium motor

Low-frequency:

1" (25 mm) voice coil, 8" (203 mm) woofer

Ceramic 20 oz. (622 gr) magnet

System Impedance:

8Ω nominal

Polar Dispersion:

170 degrees vertical and horizontal

Dimensions:

Width: 15-7/8" (403 mm)

Height: 22" (559 mm)

Mounting Depth: 2-1/2" (64 mm)

Product Weight:

14.5 lbs. (6.6 kg) each

Shipping Weight:

18 lbs. (8.1 kg) shipped as a single panel

Included Accessories:

Mounting shims

Mounting screws

Terminal wrench

Optional Accessories:

[PS-22 PlaceSaver®](#)

[BX-22 MDF Acoustic Back Box](#)

[MBX-22 UL Listed Metal Back Box](#)

[MBA-22 UL Listed Metal Back Box – Adjustable](#)

[MBC-22 Concrete Back Box](#)

[SK-1 Shim Kit](#)

[CVXMR 100, 75 and 25 volt Constant Voltage Transformers](#)

[WARRANTY](#) – Extended Warranty 15 year



255R Monaural Subwoofer Amplifier



The Stealth Acoustics 255R is an integrated monaural subwoofer amplifier / crossover system designed as a low distortion power source for Stealth Acoustics wall or ceiling mounted, invisible subwoofer panels or other un-powered subwoofer speakers. Intended for whole house audio or home theater bass applications, the 255R may stack with other components or mount in a standard 19" equipment rack requiring only two RU spaces (3-1/2"). Removable rack mount ears are provided. The 255R delivers a solid 250 watts into an 8Ω load and 350 watts into 4Ω. A variable low pass, 18db per octave filter allows for infinite crossover points from 50Hz to 100Hz.

With a full complement of input and output connectors, the 255R is easily integrated into any a system. Inputs include RCA line level, balanced XLR line level, and 5-way binding post speaker with pass-through capability. The speaker level input/pass-through connections allow the 255R directly from full-range speaker lines, anywhere in the system. The 255R's amplifier output con via a 5-way binding post designed to accept heavy guage speaker wires. A selectable automati feature activates the amplifier only when audio signals are present.

Other features include an internal, quiet, 8-stage cooling fan that automatically engages as req Front panel controls include volume control, variable low pass filter, low pass filter on/off switch control, power switch and six power output monitor LED's. 110VAC and 220VAC input line volt: selectable, via a rear panel switch.

The Stealth Acoustics 255R subwoofer amplifier is covered by a 2-Year manufacturer's warrant

Specification Sheet: [Download PDF](#)

Features and Functions	Specifications
Rack Mountable (2) RU spaces: 3-1/2" (89 mm) (Provided rack ears are removed)	Mono Power Output 250 watts @ 8 < 0.05 THD 350 watts @ 4 < 0.05 THD
DC Protected Fixed high pass filter @ 18Hz	Total Harmonic Distortion <0.05 @ 1 watt 4 / 100Hz
Variable Low Pass Filter 50 to 150Hz / 18 dB per octave	Signal to Noise Ratio 86 dB below rated output
Power Standby LED Red (blue when system is active)	Crossover Section Low Pass Filter: 50Hz – 150Hz / 18 dB per c (variable with bypass switch)
Auto On/Standby Function Switch selectable "on" or "off"	High Pass Filter: 18Hz / 30 dB per octave (fi
Flexible Inputs with Pass Through Binding post speaker level inputs / outputs	System Impedance 8Ω nominal – 4Ω minimum
RCA line level inputs / outputs	Current Draw 6.2A @ 350W/4 – 115VAC/60Hz

XLR balanced line inputs / outputs

Amplifier Output Connector

5-way binding post

Output monitor LED's

6 level readings

Phase Switch

Low Pass Filter on/off Switch

Fan Cooled

Automatic – 8 speed stages

110v and 220v Input Voltages

Dimensions

Width: 19" (482 mm)

Height: 3-1/2" (89 mm) – without feet

Depth: 13-5/8" (346 mm)

Finish

Black anodized aluminum

Product Weight

31.3 Lbs. (14.20 kg)

Shipping Weight

32.5 Lbs. (14.74 kg)

Included Accessories

Removable power cord

Removable rack ears



High Current 2 Channel Amplifier

The Stealth Acoustics SA2400 is high-current two-channel amplifier with powerful built-in digital signal processing functions suitable as a low distortion power source for Stealth Acoustics speakers, Stealth subwoofers, or other un-powered speakers and subwoofers. Intended for distributed audio, fixed installations, or home theater applications, the SA2400 mounts using the supplied removable rack ears in a standard 19" (482 mm) equipment rack requiring only two RU spaces (3-1/2" – 89 mm), or may stack with other free-standing components. The SA2400 delivers a solid 310 watts per-channel into an 8Ω load and 450 watts per-channel into 4Ω.

The SA2400's internal DSP functions may be programmed for each channel independently or together and include 11 bands of fully-parametric EQ, variable High and Low Pass filters with selectable slopes, fully-programmable limiter stage and delay functions. All parameters may be programmed using front panel controls or via a USB connected computer utilizing Stealth Signal Management System software (SSMS).

For maximum flexibility integrating into any audio system, the SA2400 includes RCA unbalanced line level, balanced XLR line level, and phoenix speaker level inputs for each channel, all with "pass-through" output connectors. The speaker level input/pass-through connections allow the SA2400 to feed directly from full-range speaker lines, anywhere in the system. A stereo optical input is provided for connecting digital sources to the amplifier. Inputs may be mapped to either channel and may be "mono-summed" via programming. The SA2400 amplifier output connections are via 5-way binding posts designed to accept heavy gauge speaker wires.

A selectable automatic turn-on feature activates the amplifier only when audio signals are present. Quiet 8-stage cooling fans automatically engage as required. The front panel includes direct master volume and menu access controls as well as an LCD display window and dual clip indicators. 115VAC and 230VAC input line voltages are easily selectable via a rear panel switch. The Stealth Acoustics SA2400 amplifier is covered by a 2-Year manufacturer's warranty.

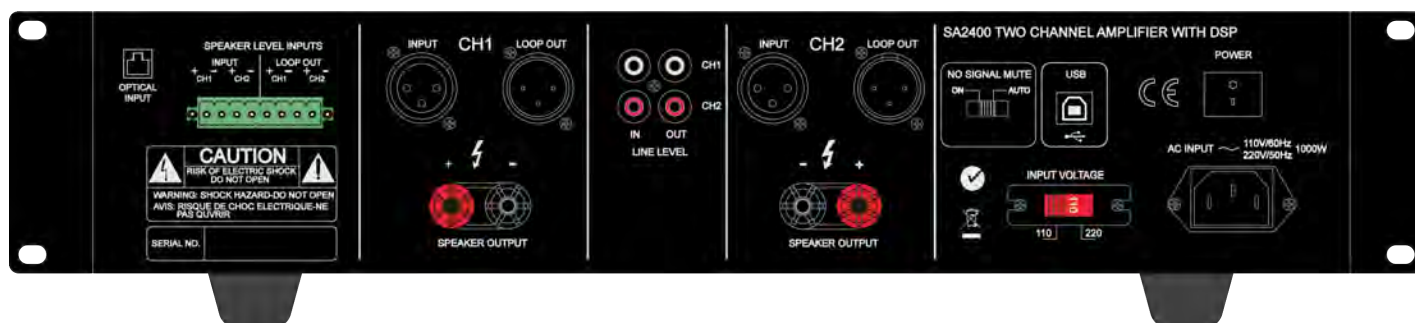

Specification Sheet: [Download PDF](#)

Download [Stealth Signal Management System](#) (For Windows operating Systems Only)

Features and Functions

Flexible Inputs with Pass Through

Phoenix connector speaker level inputs / outputs RCA unbalanced line level inputs / outputs XLR balanced line level inputs / outputs
Optical Digital input (stereo TOS – routable, no pass through output)

Amplifier Output Connectors

5-way binding posts (each channel)

Front Panel LCD Display

Input level readout Programming / parameter display Dimming function (3 levels)

USB Connection

For Computer programming of DSP features via SSMS software

Auto On / Standby Function

Switch selectable “On” or “Auto”

Fan Cooled

Automatic – 8 speed stages

115V-60Hz and 230V-50Hz Selectable Input Voltages

Rack Mountable

(2) RU spaces: 3-1/2” (89mm)

Product Specifications

Power Output (per channel – both channels driven)

310 watts @8Ω < 0.05 THD

450 watts @4Ω < 0.05 THD

Frequency Response

20Hz-50kHz (+1/-3dB)

Total Harmonic Distortion

< 0.05 @ 450 watt @4Ω / 1 kHz

Signal to Noise Ratio

>105 dB / A weighting 20Hz-20kHz

Analog Input Sensitivity

-1dBV for output of 312.5W / 8Ω

Maximum Voltage Gain

36 dB / 8Ω

Crosstalk

>85dB

System Impedance

8Ω Nominal – 4Ω Minimum

Full Output Current Draw

1080 watts @115V / 8 Ω (100Hz sine wave – both channels driven)

1560 watts @115V / 4 Ω (100Hz sine wave – both channels driven)

Typical audio power current draw is 1/8 to 1/4 Full Output Current Draw, depending on source material / load

Amplifier / Load Protection

Full short circuit, open circuit, thermal, ultrasonic and RF protection

On/Off muting with auto volume ramp up on power-up

DC fault power supply shutdown

Fixed high-pass filter @18Hz

Stable into reactive or mismatched loads

Shipping Weight

38 lbs. (17.2 kg)



Recommended Applications:

Use the on installations into masonry, hat-channel type suspended ceilings where the space behind the speaker panel is open, or where a metal enclosure behind the speaker is required. This product is also useful to assist in installations where sound transfer from one floor or room to the next is of concern.

Construction:

Constructed of 1.2 mm thick metal, MBC back boxes are shipped fully assembled. Convenient knockouts for conduit are provided, 1 each on the top and bottom of the box. The knockouts will accept 1/2" (13 mm) conduits and loom clamps. The MBC back box is lined on all four sides with 3/4" (19mm) plywood to provide solid mounting surfaces for the speaker panel.

Included Accessories:

Light Insulation.

Optional Accessories:

Dynil™ by Dynamic Control (dynamat.com)

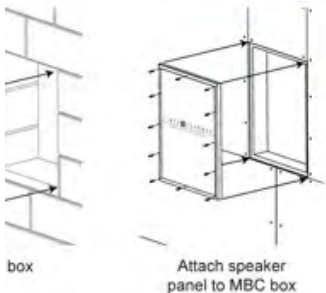

Wall Application

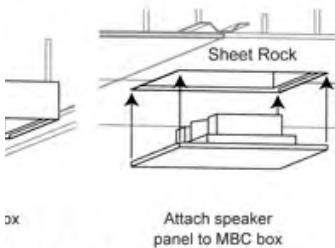

Ceiling Application

Specification Sheet: [Download PDF](#)

Model	For Speakers	Width	Height	Depth	Ship Weight
MBC-30	LR3, B30	16-1/8" (409 mm)	30-1/8" (765 mm)	3-15/16" (98 mm)	18 lbs. (8.2 kg)
MBC-22	LR8, B22, SLR8, LR4-B22	16-1/8" (409 mm)	22-1/8" (562 mm)	3-15/16" (98 mm)	14 lbs. (6.4 kg)
MBC-12	LR6, LR4-HM	16-1/4" (412 mm)	12-1/8" (308 mm)	3-15/15" (98 mm)	9 lbs. (4 kg)

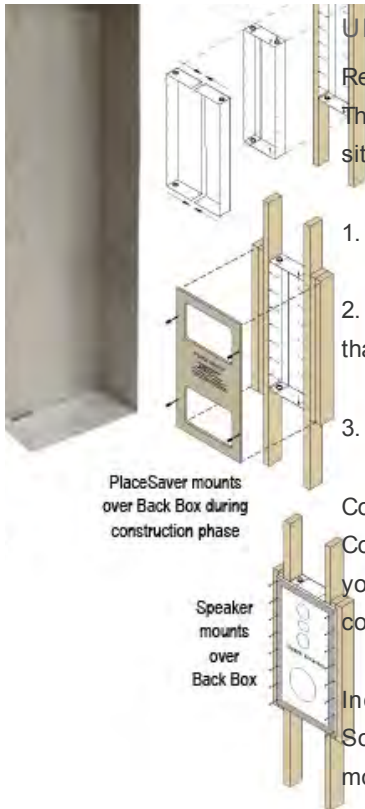

UL LISTED

Recommended Applications:

The versatile, UL listed MBA back boxes are built to adapt to whatever you have to work with on the job site. MBA back boxes are recommended for installations:

1. Where the space behind the speaker is open;
2. Where a metal closure is required and the mounting distance between the framing members is less than 16" (406 mm) on center;
3. When using metal studs or hat channel/suspended hard lid ceilings.

Construction:

Constructed of 1.1 mm thick metal, the MBA series back boxes are shipped unassembled, ready for your custom configuration needs and UL listed. Convenient 1/2" (13 mm) and 3/4" (19 mm) knockouts for conduit are provided.

Included Accessories:

Screw package and foam pads Dynamat adhesive box insulation 3/4" (19 mm) x 1-1/2" (38 mm) metal mounting angles.

Specification Sheet: [Download PDF](#)

Model	For Speakers	Width	Height	Depth	Ship Weight
MBA-30	LR3 , B30	9-3/4" to 14-1/2" (247 – 368 mm)	30" (762 mm)	3-1/2" (89 mm)	13 lbs. (5.9 kg)
MBA-22	LR6 , LR8 , B22 , SLR8 , LR4-B22 , LR4-HM	9-3/4" to 14-1/2" (247-368 mm)	22" (559 mm)	3-1/2" (89 mm)	10 lbs. (4.5 kg)

MBX

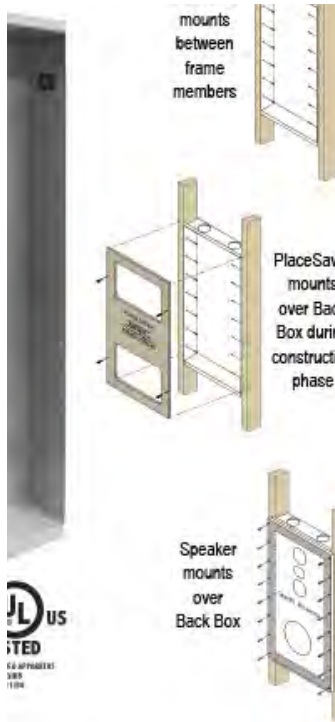

UL LISTED

Recommended Applications:

We recommend using the BX-30 (for LR3 and B30 panels) or the BX-22 (for all other Stealth Acoustic speaker panels) metal back boxes on installations where the space behind the speaker panel is open, or where a metal enclosure behind the speaker is required. Measuring 3-1/2" (89 mm) deep, the MBX series of back boxes will fit into standard 2x4 stud bays or larger apertures and are designed to fit in between 16" (406 mm) on-center studs. MBX back boxes can be used in walls or ceilings. This product is also useful to assist in installations where sound transfer from one floor or room to the next is of concern.

Construction:

Constructed of 1.1 mm thick metal, MBX back boxes are shipped fully assembled and are UL listed. Convenient knockouts for conduit are provided, 2 each on the top and bottom of the box. The knockouts will accept either 1/2" (13 mm) or 3/4" (19 mm) conduits and loom clamps.

Included Accessories:

Screw package and foam pads.

Optional Accessories:

Metal Stud C-Channel Blocking Kit (CC-Kit).

Specification Sheet: [Download PDF](#)

Model	For Speakers	Width	Height	Depth	Ship Weight
MBX-30	LR3g, B30g	14-1/2" (368 mm)	30" (762 mm)	3-1/2" (89 mm)	13 lbs. (5.9 kg)
MBX-22	LR8g, B22g, SLR8g, LR4G-LF	14-1/2" (368 mm)	22" (559 mm)	3-1/2" (89 mm)	10 lbs. (4.5 kg)
MBX-12	LR6G, LR4G-HM	14-1/2" (368 mm)	12" (305 mm)	3-1/2" (89 mm)	8 lbs. (3.6 kg)



BX MID BACK BOX

The BX box is ideal for both new construction and when retrofitting Stealth speakers into existing walls or ceilings where there are no plenum requirements. The BX enclosure helps with sound isolation and speaker performance

Constructed of man-made wood, The BX back boxes are shipped assembled and painted. A terminal cup with speaker wire pigtails allow the back box to be attached to the speaker before the speaker is installed. Roxul™ insulation is included for the interior of the box.

PRE-INSTALLATION NOTE:

Use the appropriate Stealth Acoustic [PlaceSavers®](#) to reserve the location of the speakers at the rough-in stage of installation. The back boxes install with the speakers after the drywall has been hung, but before taping begins.

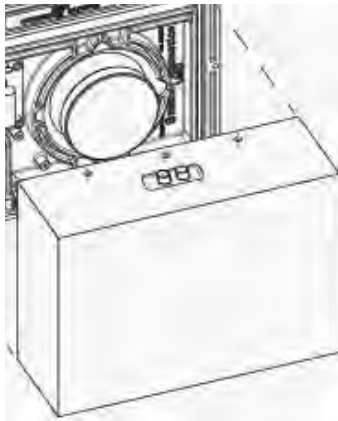

Specification Sheet: [Download PDF](#)

Mounting Detail provided to secure backbox to the speaker's raised baffle box prior to

Model	For Speakers	Width	Height	Depth	Ship Weight
BX-30	LR3G , B30G	11" (279 mm)	28" (711 mm)	3-1/2" (89 mm)	12 lbs. (5.4 kg)
BX-22	LR8G , B22G , LR4G-LF	11" (279 mm)	20-1/4" (514 mm)	3-1/2" (89 mm)	10 lbs. (4.5 kg)
BX-22SLR	SLR8G	11" (279 mm)	20-1/4" (514 mm)	3-1/2" (89 mm)	10 lbs. (4.5 kg)
BX-12	LR6G	10" (254 mm)	14" (356 mm)	3-1/2" (89 mm)	6 lbs. (2.7 kg)



The Shim Kit allows for the speaker panels face to be shimmed out further depending on the fin method. Each kit contains both 1/16" (1.6 mm) and 1/8" (3.2 mm) thick shims in bundles of 25.

Shipping weight: 5 lbs. (2.3 kg).

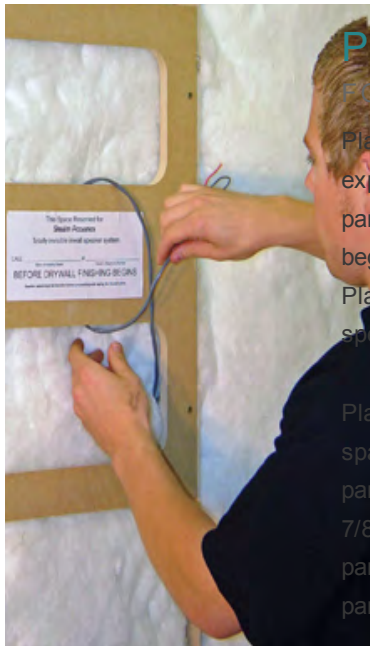

Pre-Installation Brackets

FOR NEW CONSTRUCTION INSTALLATIONS

PlaceSavers® are for temporary use on new construction. The greatest exposure to damage occurs during the time the Stealth Acoustic speaker panels are first mounted to the structural framing and when the taping begins. Particularly during the time when the drywall board is hung. PlaceSavers® keep this exposure to a minimum by reducing the raw speaker panels exposure to the construction site.

PlaceSavers® are built from 1/2" MDF and are sized slightly larger than the speaker panel it is reserving space for. This insures that no matter how tight the drywall is hung to the PlaceSaver®, the speaker panel will easily drop into place when the Place Saver is removed. The PlaceSavers® have 1/8" deep x 7/8" wide grooves on the back side that match the mounting flanges on the Stealth Acoustic speaker panels. This insures that if the PlaceSaver® is centered properly on the structural framing the speaker panel will be also.

PlaceSavers® should be installed at the pre-wire stage and replaced with the speaker panel just before drywall finishing begins. PlaceSavers® have labels on the front with space to write in the Stealth Acoustic Dealer name and phone number. They are packaged 6 per carton and come with mounting screws. They are also reusable if your installers remember to bring them back from the job site.

Shipped 6 per box (3 pair).

Specification Sheet: [Download PDF](#)

Model	For Speakers	Width	Height	Ship Weight
PS-30	LR3G, B30G	16" (406 mm)	30" (762 mm)	27 lbs. (12.2 kg)
PS-22	LR8G, SLR8G, B22G, LR4G-LF	16" (406 mm)	22" (559 mm)	17 lbs. (7.7 kg)
PS-12	LR6G, LR4G-HM	16" (406 mm)	12" (305 mm)	11 lbs. (5 kg)